

GENERAL NOTES.

ALL LEVELS AND DIMENSIONS SHOWN ON THIS DRAWING ARE TO BE VERIFIED ON SITE BY THE CONTRACTOR PRIOR TO COMMENCEMENT OF WORK.

ALL DIMENSIONS ARE TO BE CHECKED ON SITE AGAINST THE ARCHITECT'S DRAWINGS.

ALL SETTING OUT IS TO BE DONE ACCORDING TO THE ARCHITECT'S DRAWINGS.

ANY DISCREPANCIES SHOWN ON THIS DRAWING IS TO BE REPORTED TO THE ENGINEER.

ALL WORK IS TO BE DONE IN ACCORDANCE WITH THE LOCAL AUTHORITY BY-LAWS.

DIMENSIONS ARE NOT TO BE SCALED OFF THIS DRAWING.

ALL REINFORCED CONCRETE WORK IS TO BE DONE IN ACCORDANCE WITH SABS 0100 OR LATEST AMENDMENT THEREOF.

ALL STRUCTURAL STEELWORK IS TO BE DONE IN ACCORDANCE WITH SABS 12004-1989 OR LATEST AMENDMENT THEREOF.

THE CONTRACTOR IS RESPONSIBLE FOR MAINTAINING THE REINFORCEMENT IN THE CORRECT POSITIONS AT ALL TIMES.

NO CAST OF CONCRETE IS TO BE UNDERTAKEN WITHOUT THE ENGINEER'S APPROVAL.

ALL CONCRETE IS TO BE VIBRATED.

ALL STRUCTURAL TIMBER WORK IS TO BE DONE IN ACCORDANCE WITH SABS 082-1988 OR THE LATEST AMENDMENT THEREOF.

ALL STRUCTURAL BRICKWORK IS TO BE DONE IN ACCORDANCE WITH SABS 0145-1978 AND SABS 0164-1980.

ALL WATERPROOFING TO ARCHITECTS OR SPECIALISTS DETAILS AND SPECIFICATIONS.

ALL STRUCTURAL TIMBER WORK IS TO BE APPROVED BY THE ENGINEER.

REINFORCED CONCRETE

MAXIMUM ALLOWABLE GROUND BEARING PRESSURE = 100 kN/m²

ALL STRUCTURAL CONCRETE TO BE 30 MPa AT 28 DAYS UNLESS OTHERWISE STATED.

COVER TO REINFORCEMENT:

SLAB	20MM
BEAMS	30MM
COLUMNS	30MM
RETAINING WALLS	20MM
FOUNDATIONS	50MM

LOADBEARING BRICKWORK
MASONRY UNITS - MINIMUM COMPRESSIVE STRENGTH TO BE 15 MPa
MORTAR - CLASS 2

TOP OF LOADBEARING WALLS TO BE FINISHED WITH STEEL TROWELLED MORTAR BED - TWO LAYERS OF PLASTIC BONDBREAKER TO BE LAID ON WALL PRIOR TO CASTING OF CONCRETE

ALL EXPOSED CONCRETE EDGES TO BE CHAMFERED 25mm

ALL EXCAVATIONS AND TRENCHES TO BE APPROVED BY THE ENGINEER PRIOR TO CASTING OF FOOTINGS AND / OR BASES.

ALL REINFORCING STEEL TO BE APPROVED BY THE ENGINEER PRIOR TO CASTING OF CONCRETE.

CONTRACTOR IS RESPONSIBLE FOR MAINTAINING REINFORCING STEEL IN POSITION DURING POURING OF CONCRETE.

3 CONCRETE CUBES TO BE TAKEN FOR EACH NEW BATCH OF CONCRETE MIXED. CONTRACTOR TO ARRANGE FOR TESTING AT 7, 14 AND 28 DAYS. THE RESULTS OF THE TESTS TO BE FORWARDED TO THE ENGINEER AS SOON AS IT BECOMES AVAILABLE.

THIS DRAWING IS TO BE READ IN CONJUNCTION WITH THE RELEVANT BIDDING SCHEDULES.

STRUCTURAL STEEL

ALL STEEL TO BE HOT ROLLED GRADE 300W STEEL UNLESS OTHERWISE STATED.

ALL WELDING TO BE 5mm FILLET WELDING UNLESS OTHERWISE INSTRUCTED BY THE ENGINEER.

PLATE THICKNESS > 12 TO 20 WELD = 6mm
PLATE THICKNESS > 20 TO 40 WELD = 8mm

ALL BOLTS TO METRIC SIZED GALVANISED BLACK BOLTS GRADE 8.8

ALL CUTTING, WELDING AND DRILLING TO CONFORM TO THE REQUIREMENTS OF SABS 0162-1984.

CUTS TO BE FREE OF ALL DIRT AND GREASE PRIOR TO WELDING.

WORKSHOP DRAWINGS TO BE FORWARDED TO THE ENGINEER FOR APPROVAL BEFORE MANUFACTURE.

STRUCTURAL STEEL CONTRACTOR TO ENSURE THAT SUFFICIENT TEMPORARY VERTICAL BRACING IS INSTALLED DURING CONSTRUCTION. THIS MAY BE REMOVED DURING CONSTRUCTION OF THE BRICK INFILL PANELS UNLESS OTHERWISE INSTRUCTED BY THE ENGINEER.

STRUCTURAL STEEL CONTRACTOR IS RESPONSIBLE FOR ALL VALLEY, HIP AND GABLE END TRIMMERS.

STRUCTURAL STEEL PAINT SPECIFICATION
SURFACE PREPARATION
ABRASIVE BLAST CLEAN TO SWEDISH STANDARD SIS 055000 OF 1967 TO SA 2.5 OR WIRE BRUSHING TO ST 3 (BLAST PROFILE 40 - 75 MICROMETRES)

PRIMER
APPLY ONE COAT OF ZINC PHOSPHATE PRIMER BY BRUSH, ROLLER OR AIRLESS SPRAY.
DRY FILM THICKNESS : 40 - 50 MICROMETRES

FINISHING COAT - 1
APPLY ONE COAT OF ALKYD MICACEOUS IRON ORE BY BRUSH, ROLLER OR AIRLESS SPRAY.
DRY FILM THICKNESS : 35 - 40 MICROMETRES

FINISHING COAT - 2
APPLY ONE COAT OF MICACEOUS IRON ORE OR SUPER ENAMEL TO COLOUR SPECIFIED BY BRUSH, ROLLER OR AIRLESS SPRAY.
DRY FILM THICKNESS : 35 MICROMETRES

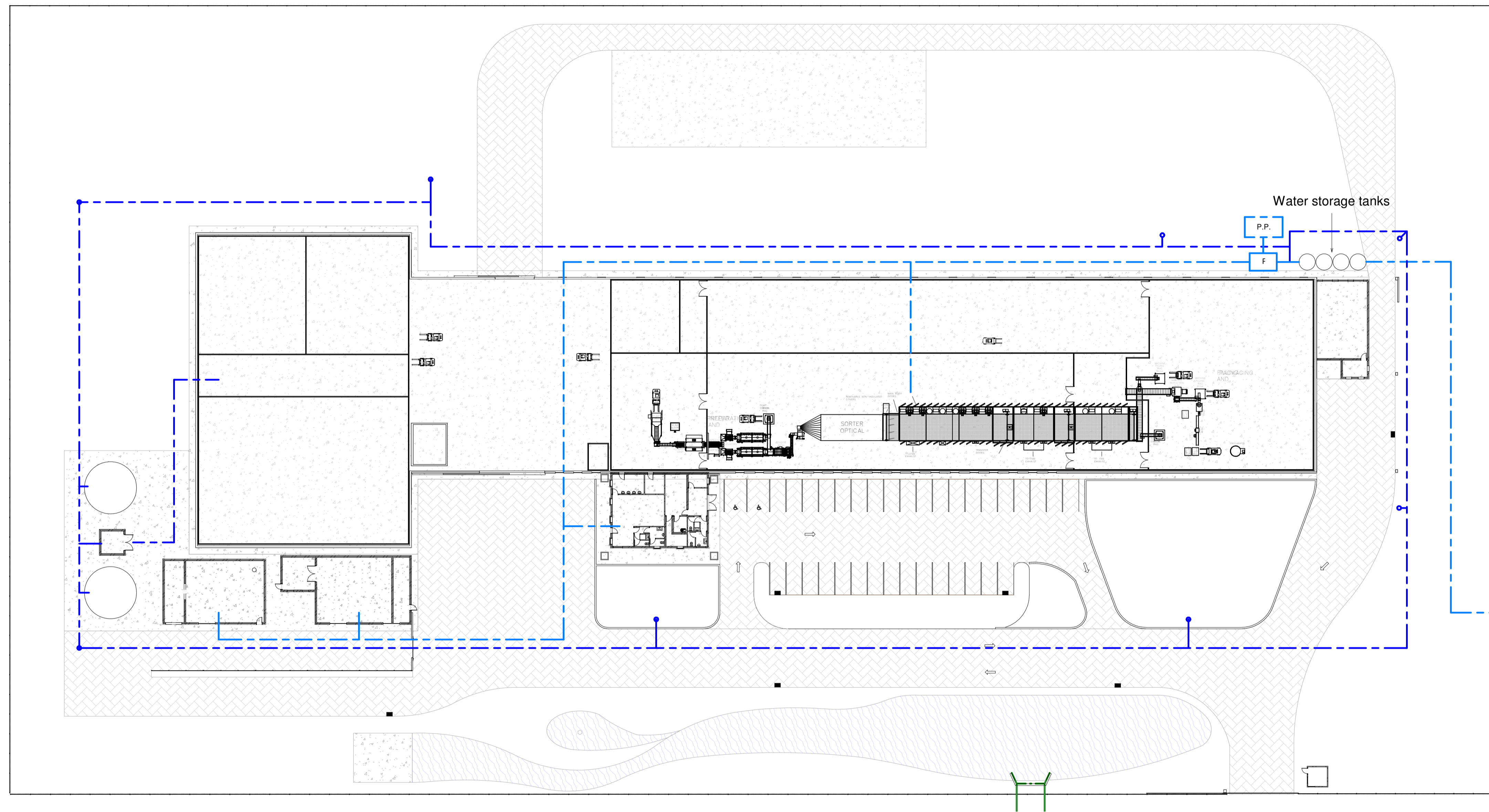
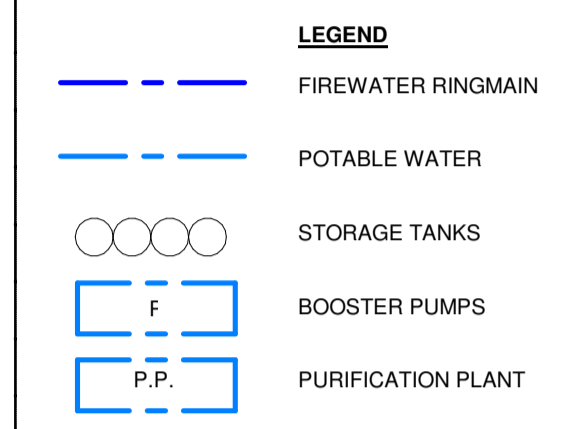

FROM BOREHOLE
100mm diameter PVC
CL 12

1 Water Reticulation Schematic
1 : 400

REV.	DESCRIPTION	DATE

M&A M. HURWORTH & ASSOCIATES cc
CONSULTING CIVIL AND STRUCTURAL ENGINEERS
PROJECT MANAGERS

Engineering World Engineering

408 GOLDENBURY ROAD
408 GOLDENBURY ROAD
P.O. BOX 51081
1024 SOUTH AFRICA
Tel: (011) 762 8200
Fax: (011) 762 8200
Email: admin@mha-engineers.co.za

Reg. No. _____
Sign. _____

PROJECT TITLE
PROPOSED NEW ONION DEHYDRATION PLANT
Site: Portion 26 of Farm 817
Client: Du Toit Invest / CBI Global

DRAWING TITLE
Reticulation Schematic

INFORMATION

DRAWN NH	DATE 15/11/2017	SCALE 1 : 400
JOB No S5034	SHEET No 4	REVISION