

- TREES**
- 0 No. *Erythrina caffra / lysistemon* (2000 Litre bag size)
 - 7 No. *Syzygium guineense* (250 Litre bag size)
 - 10 No. *Vachellia karroo* (250 Litre bag size)
- Existing trees
- Trees to be removed
- GROUNDCOVERS**
- 2 000m² *Cynodon sp.* seeding
 - Carpobrotus sp.* groundcovers
- HARD LANDSCAPING**
- 250m² Compacted laterite
 - Paving to Engineer's specification

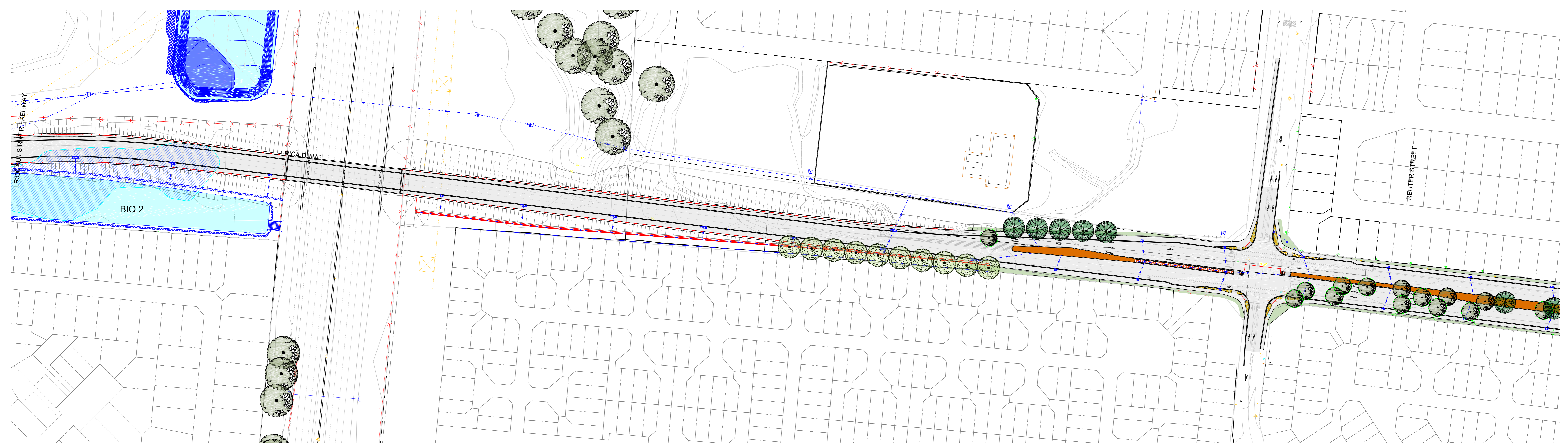
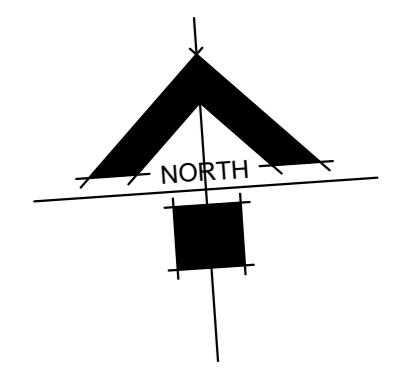

NO.	DATE	REVISION

DESIGNED:	NAME:	SIGNED:	DATE:
R.SPOLANDER	R.SPOLANDER		
DRAWN:	R.SPOLANDER		
CHECKED:	R.SPOLANDER		
SIGNED:	KOPIEREG VOORBEHOU / COPYRIGHT RESERVED		