

- TREES**
- 0 No. *Erythrina caffra* / *lysiestom* (2000 Litre bag size)
 - 0 No. *Syzygium guineense* (500 Litre bag size)
 - 0 No. *Vachellia karroo* (250 Litre bag size)
 - Existing trees
 - Trees to be removed
- GROUNDCOVERS**
- 4 400m² *Cynodon sp.* seeding
 - Carpobrotus sp.* groundcovers
- HARD LANDSCAPING**
- 1750m² Compacted laterite
 - Paving to Engineer's specification

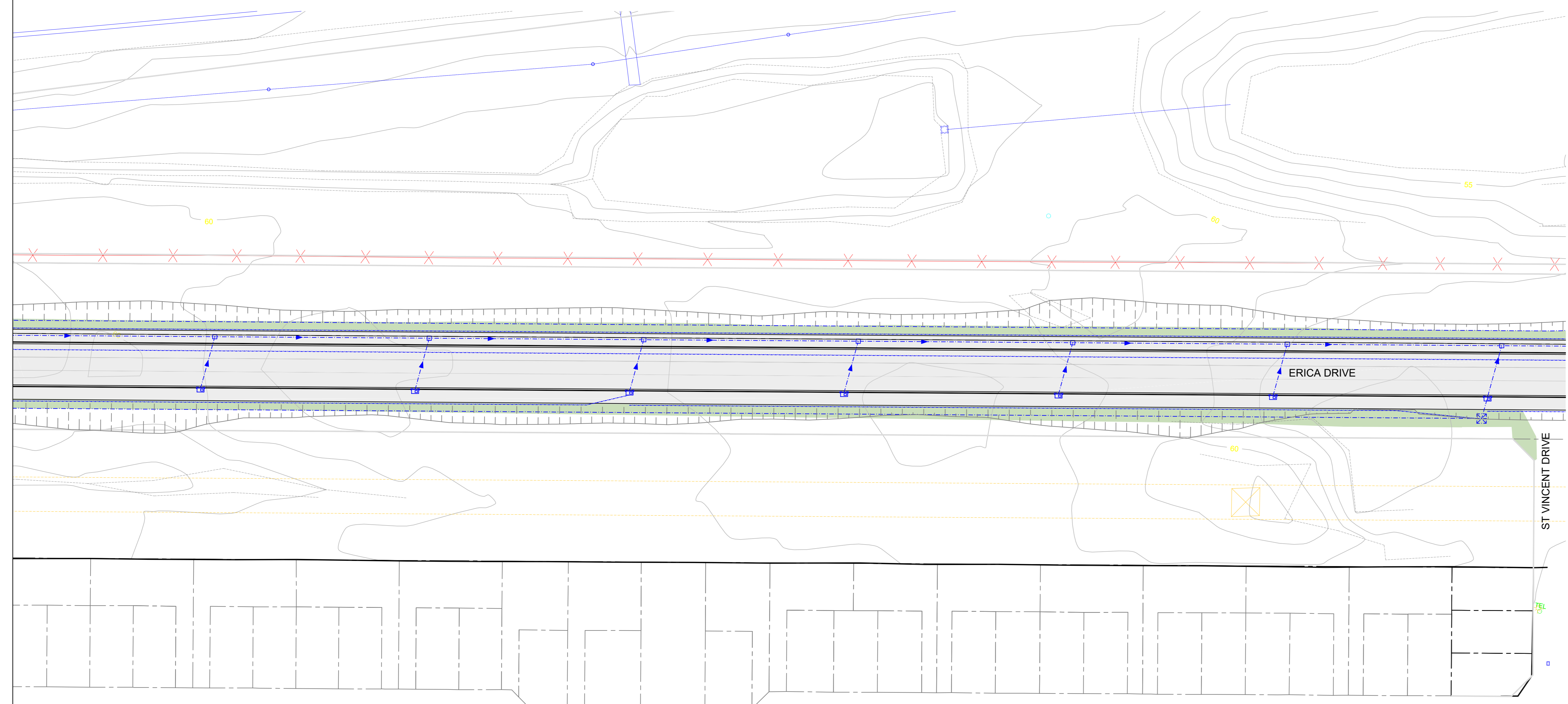
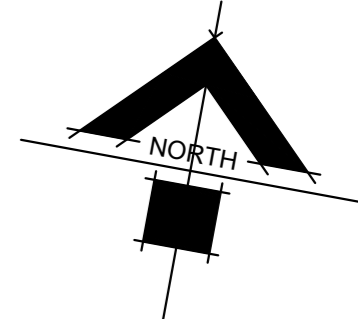

Standard clear-stemmed tree planted in the centre of the tree hole, size and species as specified.

Standard tree stakes as 2700mm long, with 2 x 70mm Ø CCA (H4) treated vertical timber members and 2 x 40mm Ø CCA (H4) treated horizontal members, with approved fang and compacted to 90% Mod ASSHTO around base of timber stake

Form a neat edge to the existing soil / lawn in line with the outside edge of the tree guard and maintain as a neat edge. Make a 50mm low lying soil trough around tree to catch & retain stormwater

2 x 40mm Ø CCA treated SA Pine horizontal members to be securely nailed to the uprights and 1 x 40mm Ø CCA treated SA Pine horizontal members to be securely nailed to the base of the 2 stakes

Tree hole 1.2m x 1.2m x 1m deep excavated and filled with approved topsoil/compost/fertiliser mix.

2 x underground 110mm Ø PVC irrigation ducts laid side by side

500 micron Root barrier to inside edge of tree holes to all trees closer than 1m to any service / 3m to any electrical service

DETAIL SECTION SCALE 1:25

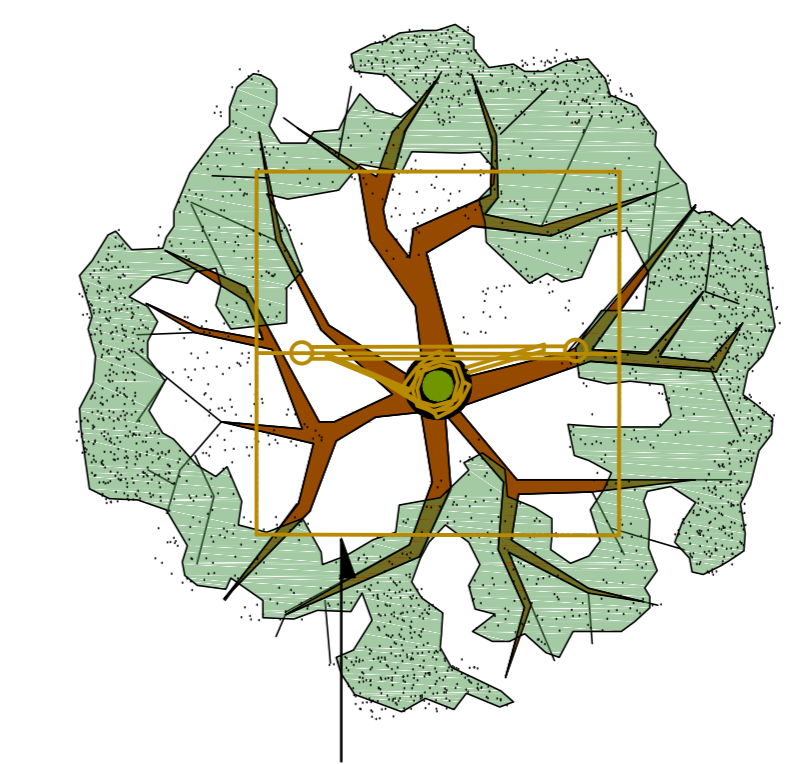
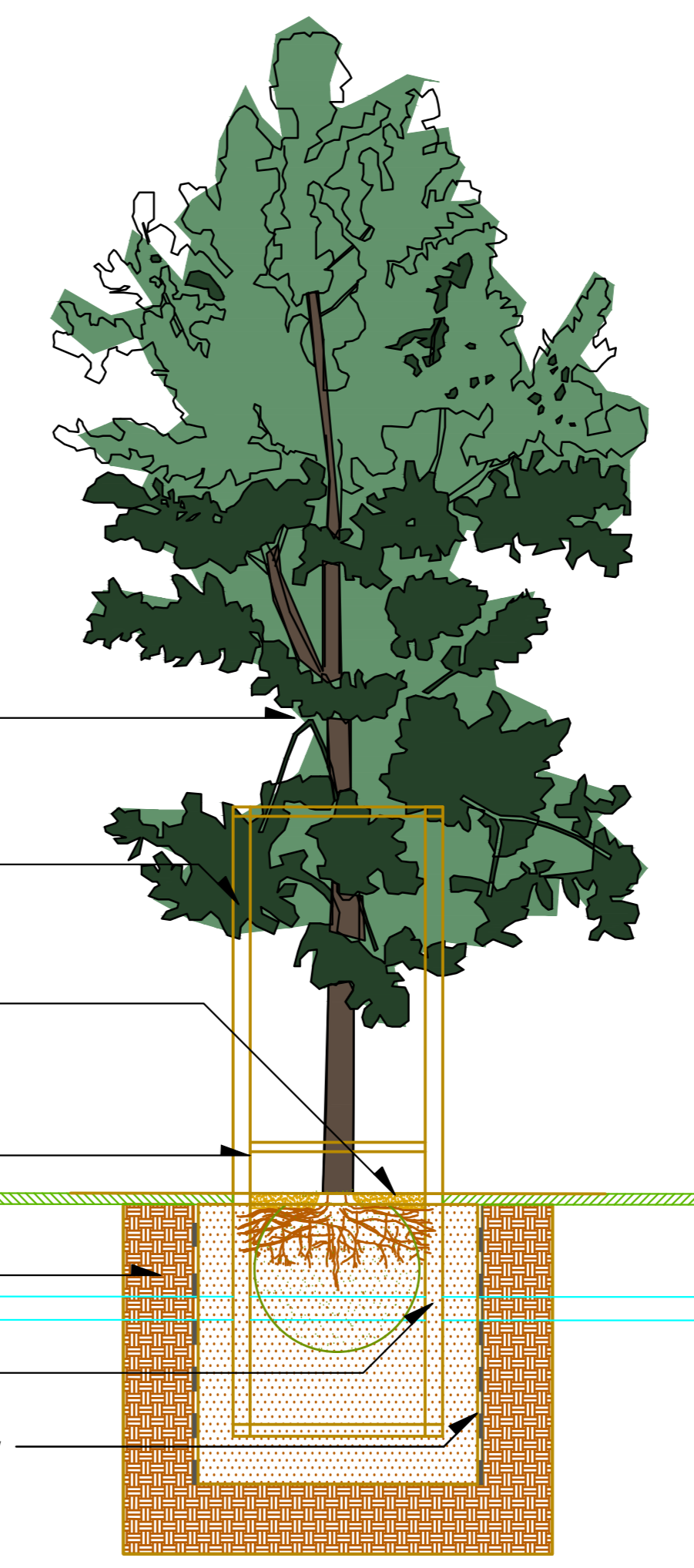

Extent of tree hole 1.2x1.2x1m deep
DETAIL PLAN SCALE 1:25

Standard clear-stemmed tree planted in the centre of the tree hole, size and species as specified.

Standard tree stakes as 2700mm long, with 2 x 70mm Ø CCA (H4) treated vertical timber members and 2 x 40mm Ø CCA (H4) treated horizontal members, with approved fang and compacted to 90% Mod ASSHTO around base of timber stake

Timber tree box consisting of 38x152x1500mm long CCA treated timber, with 3 No. nails to each corner secured in position to timber corner upright. 200x200x150mm deep in-situ concrete footing to all vertical timber corners, to secure uprights in position. 2 No. 100mm long nails to be driven into timber uprights

2 x 40mm Ø CCA treated SA Pine horizontal members to be securely nailed to the uprights and 1 x 40mm Ø CCA treated SA Pine horizontal members to be securely nailed to the base of the 2 stakes

Tree hole 1.2m x 1.2m x 1m deep excavated and filled with approved topsoil/compost/fertiliser mix.

2 x underground 110mm Ø PVC irrigation ducts laid side by side

500 micron Root barrier to inside edge of tree holes to all trees closer than 1m to any service / 3m to any electrical service

DETAIL SECTION SCALE 1:25

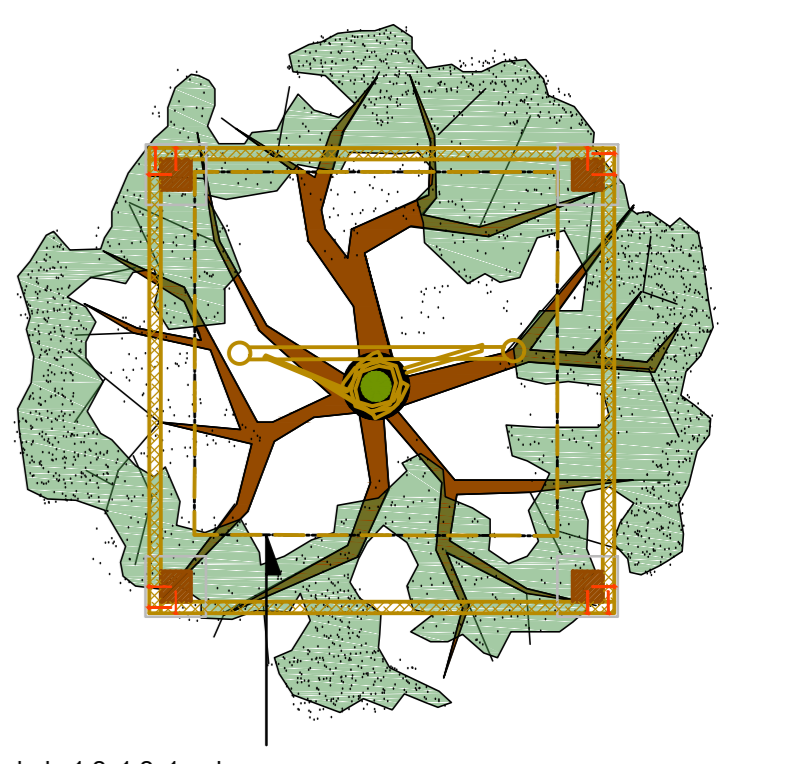
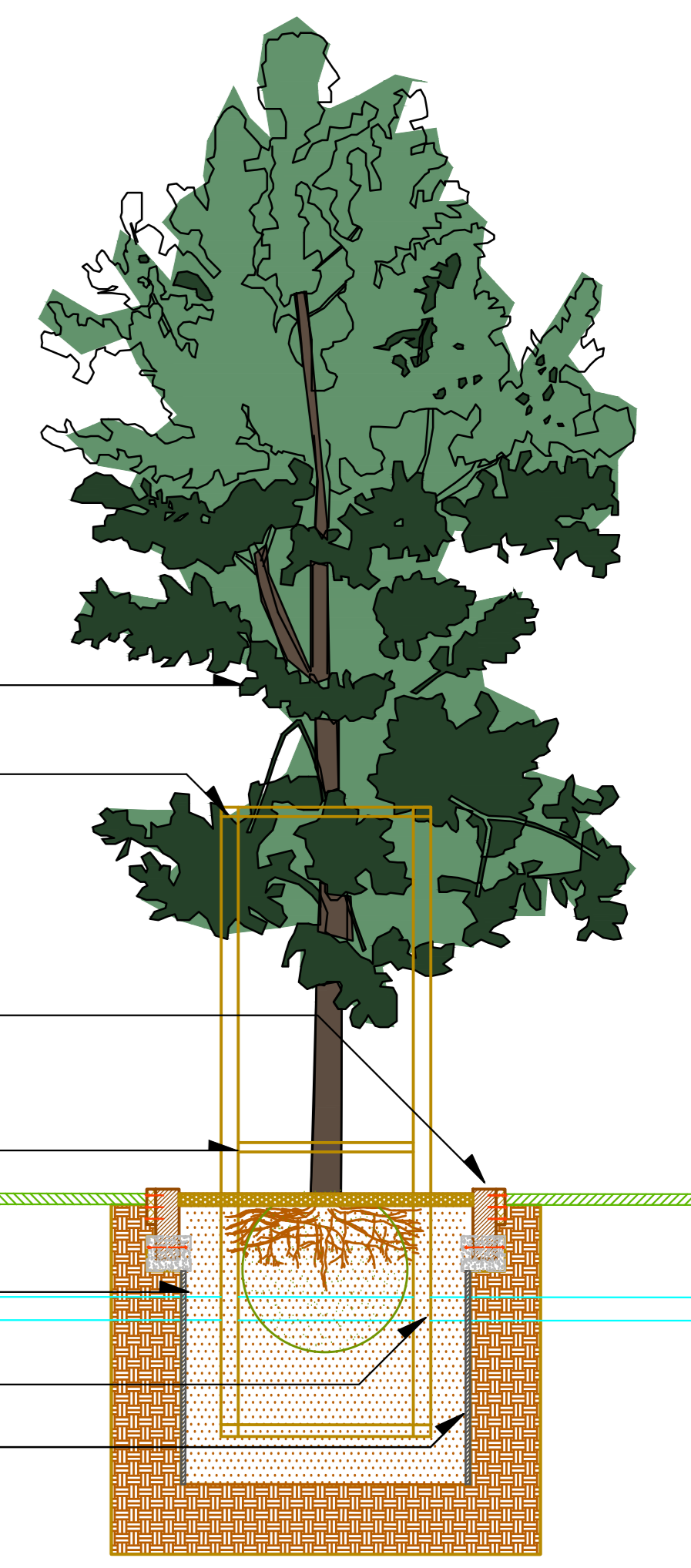

Extent of tree hole 1.2x1.2x1m deep
DETAIL PLAN SCALE 1:25

NO.	DATE	REVISION	SIGNED

DESIGNED: R.SPOLANDER
DRAWN: R.SPOLANDER
CHECKED: R.SPOLANDER

NAME: _____
SIGNED: _____
DATE: _____

PROJECT: 3785.4 CITY OF CAPE TOWN EASTERN REGION
ERICA DRIVE ACROSS THE R300 BETWEEN BELHAR DR AND HIGHBURY RD
M71 ERICA DRIVE
LANDSCAPE SKETCH PLAN 1

DRAWING TITLE: _____

COPIEREG VOORBEHOU / COPYRIGHT RESERVED